

Series 2701

2" Impact/Blast Grade Fixed/Projected/Casement Windows



CONFIGURATIONS

Project-Out • Casement Out • Fixed

Designed for educational, office and healthcare facilities, this window system is an attractive product for a wide range of configurations and applications. This product is approved for use in High Velocity Hurricane Zone (HVHZ). Florida Product Approvals 12912.1, 12912.2, 14628.1, 14831.1 and 14831.2.

Features

E-Strut™ thermal isolator

Angle reinforced vent corners

Pressure equalization

Anodized or painted finishes available

Benefits

Completely eliminates dry shrinkage

Improves thermal performance and enhances energy saving potential

Improves sash/vent rigidity

Superior water resistance

Multiple options to answer economic and aesthetic concerns



Series 2701

2" Impact/Blast Grade Fixed/Projected/Casement Windows

Main Frame Construction

The frame is constructed from .125" nominal material wall thickness aluminum of 6063-T6 alloy with a depth of 2". An equal leg frame is standard. Corners are mortise and tenon construction, and back sealed with small-joint seam sealer. See Illustration 1.

Vent Frame Construction

The 2" deep vent consists of tubular aluminum members with .125" nominal material wall thickness of 6063-T6 alloy. Vent corners are mitered, angle reinforced, crimped, cold epoxy welded, and back sealed with small-joint seam sealer. See Illustration 2.

Weather Stripping

All vents are dual weather-stripped with a dual durometer Santoprene® gasket. The exterior gasket is intentionally omitted at the vent bottom rail for project-out vents and at the vent top rail for project-in vents, allowing air to pressure equalize the void between the vent and frame. Each vent utilizes the pressure equalization technique for superior water resistance. Two holes or slots per vent through the window frame facilitate weepage.

Screens

Screen frames are extruded 6063-T6 aluminum alloy. Full width hinged wickets or fully hinged screens are available. 18 x 16 mesh screens are available in fiberglass and .011" diameter aluminum. 18 x 18 mesh screens are available in .009" diameter stainless steel.

Thermal Barrier

All perimeter frames are thermally isolated with two thermal struts consisting of glass reinforced polyamide nylon, mechanically crimped in raceways extruded in the exterior and interior extrusions. All vents and intermediate rails are thermally improved using the latest technology in two-part, high density polyurethane. See Illustration 3.

Hardware

Locking cam handles, and keepers are of cast aluminum and bronze alloy with a dove tail and groove design. 4-bar hinges are fabricated of stainless steel meeting AAMA 904.1 requirements. Butt hinges are fabricated from extruded aluminum of 6063-T6 alloy with stainless steel pins.

Glazing

Windows are inside glazed with an extruded aluminum, screw supplied glazing bead. Glazing of 9/16" to 1-1/8" can be utilized.

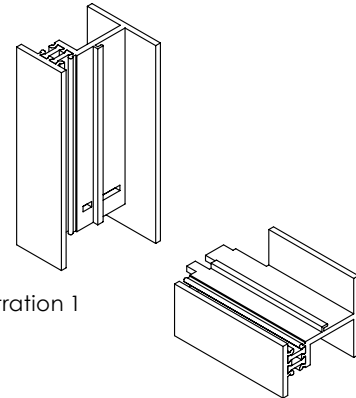

Illustration 1

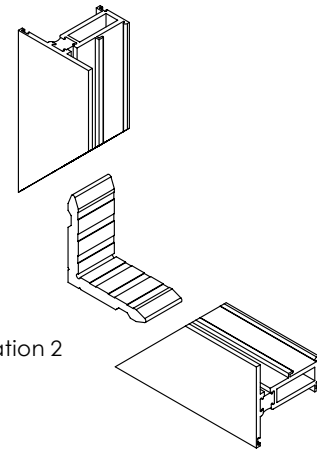

Illustration 2

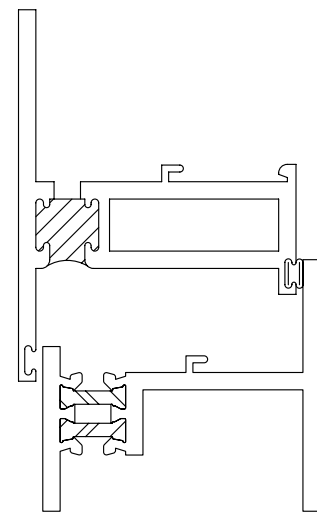

Illustration 3